

Marine Chill Water Skid Mounted Package Air Conditioners

Model # MPWC-240



FEATURES

- ❑ Built in accordance with USCG, ABS, & IEEE-45.
- ❑ Dual compressors for 100% backup systems
- ❑ Acme Sea water or fresh water cooled shell & tube condenser
- ❑ Carlyle semi-hermetic compressors
- ❑ Compact skid to fit most locations.
- ❑ Control enclosure with mounted Gauges.
- ❑ Standard heavy duty controls.
- ❑ Entire unit has a special Marine coating.

PHYSICAL DATA

Other sizes available upon request

MODEL	NOM. TONNAGE	A (IN)	B (IN)	C (IN)
MPWC-240	60	110	79	45

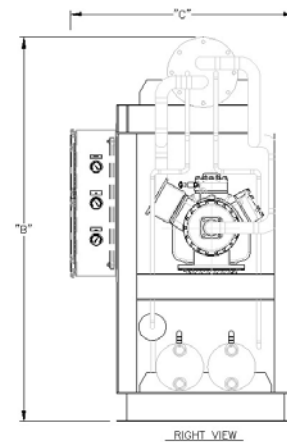
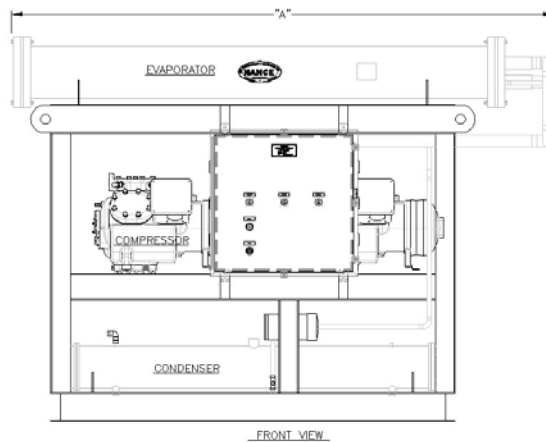

AVAILABLE ELECTRICAL CHARACTERISTICS

0	1	2	4	6	8	9
208/230-3-60	575-3-60	575-3-60	200-3-60	400/460-3-50/60	230-3-50	220/380-3-60

SPECIFICATIONS SUBJECT TO CHANGE WITHOUT NOTICE



NANCE INTERNATIONAL, INC.

Tel: (409) 838-6127 ♦ Fax: (409) 838-6219

2915 Milam St., Beaumont, Texas: 77701

Email: info@nanceinternational.com

Web: www.nanceinternational.com

- ♦ AIR CONDITIONING
- ♦ REFRIGERATION
- ♦ HEATING
- ♦ VENTILATION